

34,122 Sq. Ft. Warehouse FOR SALE

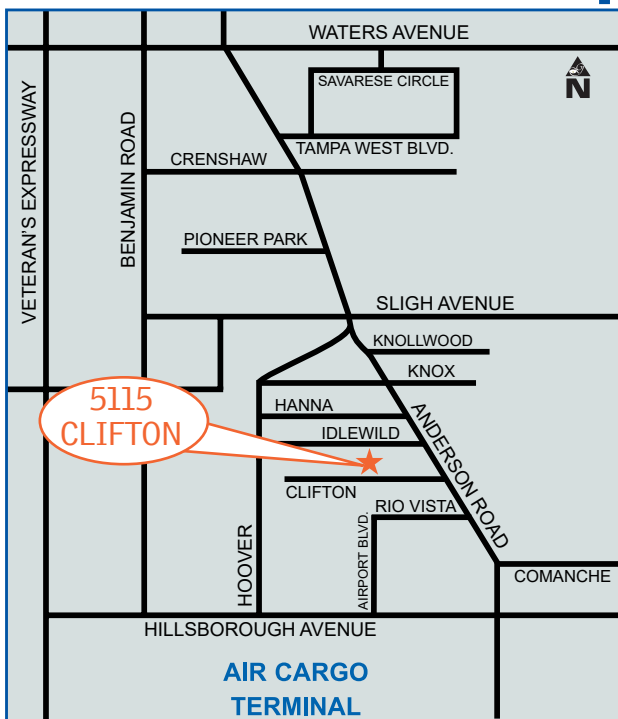

**5115 W. Clifton Street
Tampa, FL 33634**



BUILDING SIZE:	34,122 Square Feet
OFFICE:	2,320 Square Feet
WAREHOUSE:	31,802 Square Feet
LAND SIZE:	2.77 Acres
ZONING:	SPI-AP-5 (Industrial)
LOADING:	2 Dock High & 1 Ramp
CLEAR HEIGHT:	27 to 29 Feet
CONSTRUCTION:	Concrete Block and Metal
YEAR BUILT:	2006
SALE PRICE:	\$2,300,000

FOR MORE INFORMATION CONTACT:

Industrial Property Group, Inc.

Licensed Real Estate Broker

2202 N. Westshore Blvd. • Suite 200 • Tampa, FL 33607

CHRISTINA PETTI at cpetti@ipgtampa.com

Cell: 813.245.1246

www.tampaindustrialrealestate.com

No warranty or representation, expressed or implied, is made as to the accuracy of the information contained herein, and same is submitted subject to errors, omissions, change of price, rental or other conditions, withdrawal without notice, and to any special listing conditions imposed by our principals.

**5115 W. Clifton Street
Tampa, FL 33634**

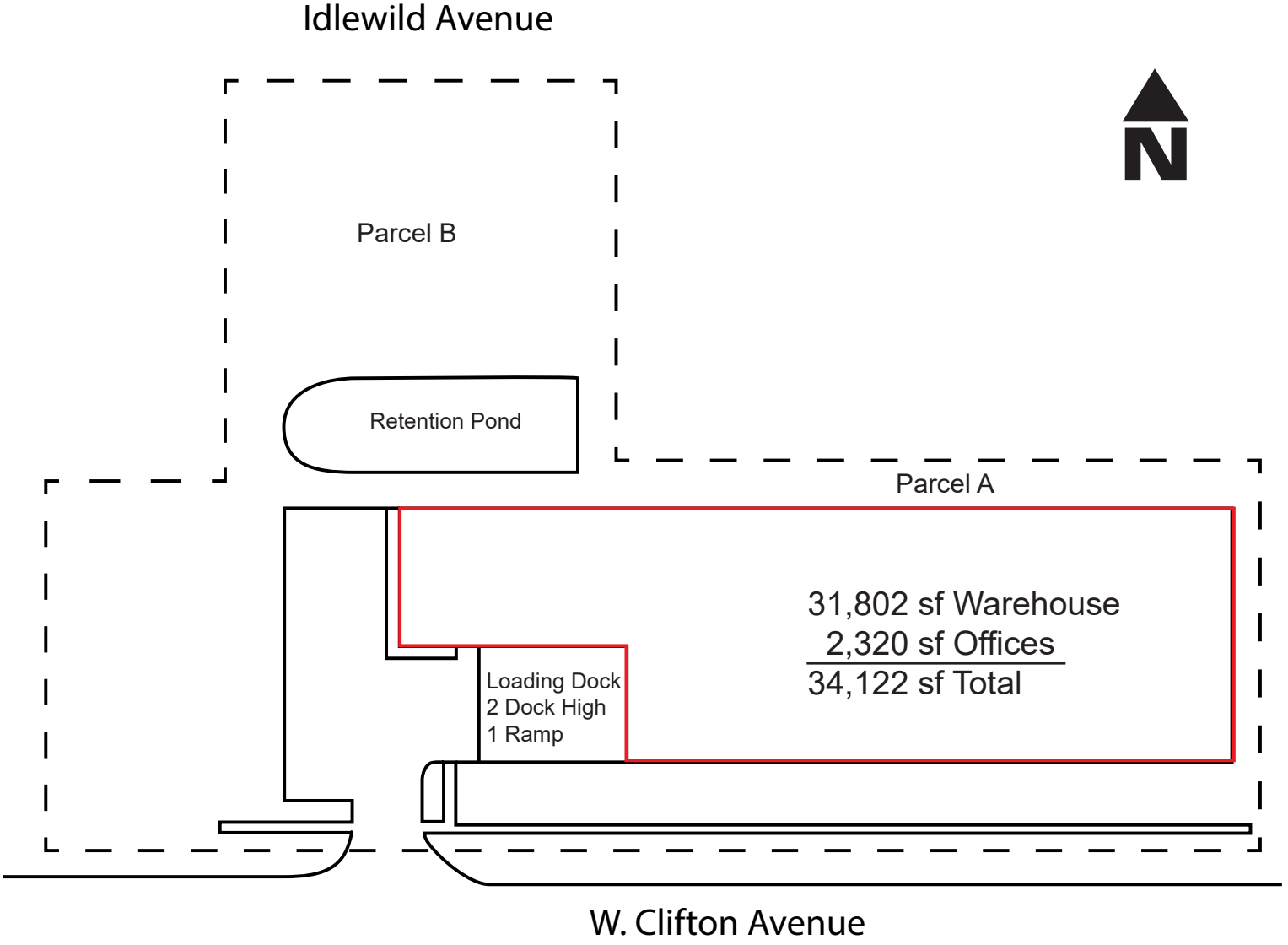

FOR MORE INFORMATION CONTACT:

Industrial Property Group, Inc.
Licensed Real Estate Broker

CHRISTINA PETTI at cpetti@ipgtampa.com

Cell: 813.245.1246

www.tampaindustrialrealestate.com

2202 N. Westshore Blvd. • Suite 200 • Tampa, FL 33607

No warranty or representation, expressed or implied, is made as to the accuracy of the information contained herein, and same is submitted subject to errors, omissions, change of price, rental or other conditions, withdrawal without notice, and to any special listing conditions imposed by our principals.